



**Star
Manufacturing
International Inc.**

10 Sunnen Drive
St. Louis, MO 63143

Phone: (314) 781-2777
FAX: (314) 781-3636

**Installation
and
Operating
Instructions**

2M-8497 REV. C 1/30/90

REV/6-14-01RDB

COUNTER MODEL POPCORN MACHINES MODELS

49, 49D, 49SL

59, 59D, 59SL

89, 89D, 89SL



GENERAL INSTALLATION DATA



CAUTION

This equipment is designed and sold for commercial use only by personnel trained and experienced in its operation and is not sold for consumer use in and around the home nor for use directly by the general public in food service locations. For equipment to be used by the general public, please contact the factory.

THOROUGHLY INSPECT YOUR MACHINE ON ARRIVAL

We do everything in our power to insure delivery of your machine in perfect condition. However there are instances in which the unit may be damaged in transit, in the event your unit is damaged in transit, have the transportation company make the necessary notations on your freight bill or delivery receipt. Immediately report this damage to the dealer from whom you purchased the machine. The dealer will advise proper handling Instructions. If damage is not discovered until after delivery has been made, notify the transportation company immediately. However, in each instance, request an inspection report to cover whatever damage has occurred in transit.

INSTALLATION

Each machine has been properly wired and inspected at the Factory for operation on the Voltage and type of Current specified on the nameplate.



CAUTION

Do not connect to any other type of current or the machine will be seriously damaged.

A receptacle is furnished with the 89 Series Popcorn machines. We strongly recommend installation by a Licensed Electrician. The guarantee of this machine as covered by the Warranty Card does not apply if an improper installation has been made.

120 VOLT MACHINES

Machines with nameplate stamped 120V, are equipped for operation on 120 Volt, 2 wire, 60 Cycle AC single phase service and must be connected to a separate 20 Amp circuit with a 3 wire grounded, polarized receptacle.

240 VOLT MACHINES

Machines with nameplate stamped 240V, are equipped for operation on 240 Volt, 2 wire, 60 Cycle AC single phase service and must be connected to a separate 15 Amp circuit with a 3 wire grounded, polarized receptacle.

GENERAL OPERATING INSTRUCTIONS



CAUTION

The motor air intake and exhaust holes located on top of the machine must be clear of any obstruction.

DO NOT COVER THESE AIR VENT HOLES as serious damage will result.

Check to insure the installation of the Corn Drawer before the Popping cycle is started. See picture for location of Corn Drawer.

With all switches in the "OFF" position, proceed in the following sequence to Pop Corn:

1.) Turn "ON" the Corn Warming switch. This switch controls the Bottom heating element, the Top heating lamp and the Sign display lamps of the Sign Lighted models.

2.) Turn "ON" the Kettle switch. This switch controls the Kettle heating element. The Red pilot light is provided to indicate when the Kettle switch is "ON". Allow six to seven minutes to pre-heat the Kettle. The Kettle heating element is thermostatically controlled. Thermostat adjustments should not be necessary as it has been preset at the factory for the correct popping temperature.

GENERAL OPERATING INSTRUCTIONS - continued

3.) Turn "ON" the Agitator Motor switch located at the right end of the motor housing. This switch will function only when the Kettle switch is in the "ON" position. If the Kettle switch is turned "OFF", the Motor will also stop. This Motor should always be running when there is corn in the Kettle. This will prevent scorching or burning of corn.

4.) A Corn and Seasoning measuring cup is supplied with your machine. Pour a level measuring cup of Oil (2 ounces - Models 49, 49D, 49SL, 59, 59D, 59SL and 3-1/2 ounces - Models 89, 89D, 89SL) in Kettle. Add a level measuring cup of raw corn (8 ounces - Models 49, 49D, 49SL, 59, 59D, 59SL and 14 ounces - Models 89, 89D, 89SL) and a Teaspoon of Popcorn Salt. Vary the amount of salt and oil to suit taste. If desired, salt may be added adfter the Corn is popped.

5.) When the Corn stops popping, dump the Kettle immediately by turning the handle clockwise approximately 90 degrees to release latch. Recharge as quickly as possible. Screen out unpopped kernels over the perforated section of the Corn pan.

6.) Turn the Kettle "OFF" when the desired amount of popping is completed.



WARNING

Do not leave the Kettle and Motor switch "ON" when the machine is not in use. Do not immerse the Kettle in water or allow water to come in contact with the Heating element.

Popping Corn in dry kettle is not recommended.

Do not connect machine to Direct Current, as this unit is designed to operate on Alternating Current only!

MAINTENANCE

Keep The Popping Unit Clean

After each popping period, wipe clean the Kettle inside and out while it is warm. This is important because if seasoning and salt are not thoroughly removed, a carbonized material will form. This condition not only lowers popping efficiency and causes excessive smoking, but could damage the unit. For retaining the high lustre on the stainless steel Kettle shell and lids, use a non-abrasive standard stainless steel cleaner when the Kettle is cold. Use a damp cloth and a warm mild soap solution to clean the glass and clear plastic surfaces.

To remove Kettle:

Turn "OFF" the Kettle motor switches. Disconnect the Twist Lock Cap at the end of the Kettle conduit, turn Kettle handle clockwise 90 degrees to unlatch the Kettle, hold the Kettle and pull out the hinge pin. The Kettle can now be removed from unit. Use asbestos gloves to remove a hot Kettle. **DO NOT PLACE THE KETTLE IN WATER**, as this will damage the electrical assembly.

To change Sign Display Lamps (on Sign Lighted Models):

Turn "OFF" all switches. Unscrew 2 sheet metal screws on the Rear side top (holding switch and pilot light panel) and 4 screws on the top. Cautiously take the top off. Cahnge bulb(s) and reassemble the top onto the frame. Tighten all six screws securely. **WARNING!** Use only inside Frosted Bulb. Wattage per label on the surface of the Top Liner. By Authorized Personnel Only.

MAINTENANCE and REPAIRS

Contact the Factory or one of its representatives or a local Service Company for Service or Maintenance required.

MATERIAL			FINISH		MODEL NO. 49, 49D		PART NO.		
DR. <i>PB</i>	CK.	DATE <i>4-24-75</i>	STAR MANUFACTURING INT'L 10 SUNNEN DRIVE ST. LOUIS,MO 63143		TITLE				
LIMITS UNLESS OTHERWISE NOTED FRACTIONS +/- 1/64 , DECIMALS +/- .005					WIRE DIAGRAM				
					CHANGES	LTR	DATE	CHANGE	DR

A	8-31-76	ADDED 49D	MM
B	2-22-77	ADDED COLOR CODE TO WIRES	JS
C	9-14-78	ADD BOTTOM WARMER	JS
D	3-25-83	SHOWED LAMP SYMBOL ON HEAT LAMP	RT
E	5-19-87	ADDED WIRE "Q"	TH
F	5-11-89	UPDATED WIRE CODES	MO

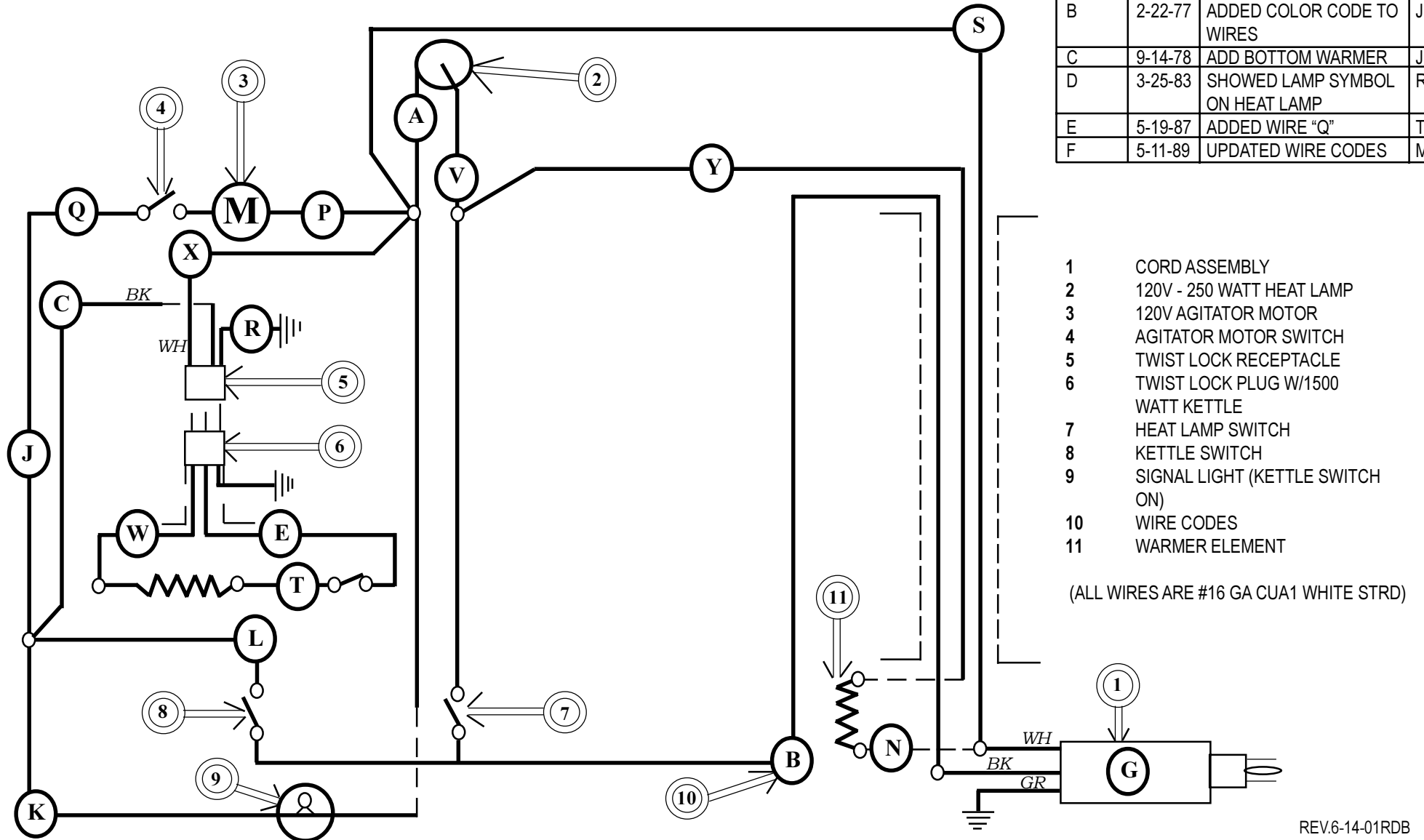

REV:6-14-01RDB

MATERIAL		FINISH		MODEL NO. 594 89		PART NO.	
DR. R. J. CK.		DATE 6-7-66		TITLE WIRING DIAGRAM 1204E40V			
LIMITS UNLESS OTHERWISE NOTED		FRACTIONS ± 1/64 DECIMALS ± .005		STAR MANUFACTURING CO. DIVISION HERCULES GALION PRODUCTS INC 9325 OLIVE BOULEVARD ST LOUIS MO. 63132			
H 5-25-83		REMOVED LAMP AND USED LAMP SYMBOL FOR OTHER		R 5 2338 CHANGED WIRE 15 AND ADDED CSA WIRING		CHANGES	
I 5-19-87		ADDED WIRE Q		R T		LTH DATE	
				TH		CHANGE	
						DELETED WIRE G 4 CHANGED WIRE LETTER T BY O X	
						ADDED LETTER B	
						CHANGED TWO LETTER F TO Y ADDED MODEL 54 AND LETTER G	
						1204 240 240 115 115 236	
						POTT-N WIRING	
						REMOVED MODEL 114 ONLY	
						WIRE 114 AND ADDED WIRE 114	

RECEPTACLE
PLUG
FLEXIBLE
CONDUIT

59⊙
89⊙
Ⓟ
HE
ELE

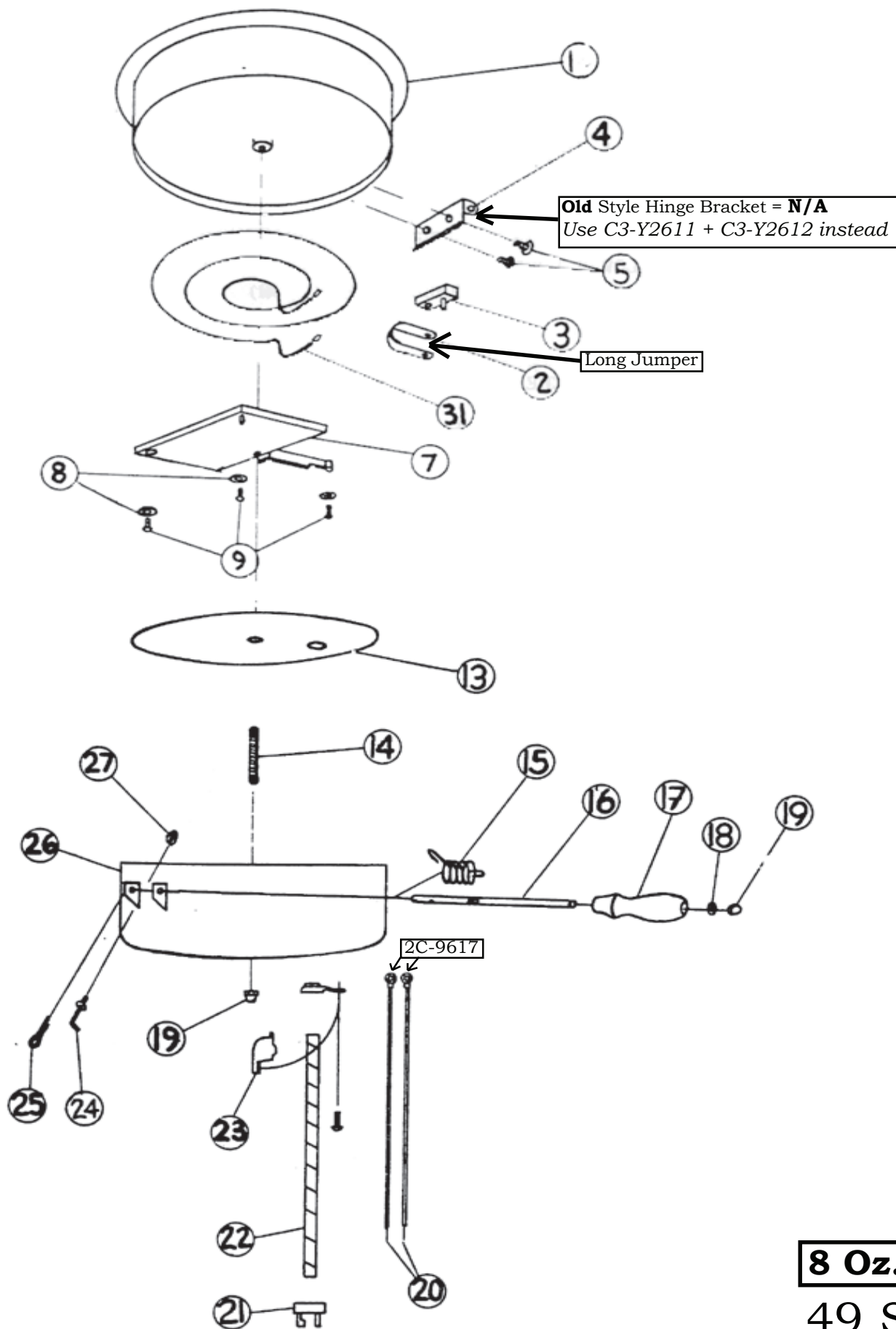

8 Oz. Kettle

49 Series

59 Series

MODEL

PARTS LIST

January 22, 2014

Model: 49 & 59 Kettle Series Popcorn Machines				
Fig No	Part Number	Qty	Description	Application
1-31	C3-49009 NLA	1	KETTLE ASSY COMPLETE	120V (49 & 59 SERIES)
	C3-49084 NLA	1		240V (49 & 59 SERIES)
	C3-59025 NLA	1		120V (59& 59D SERIES)
1	2F-8351	1	CASTING KETTLE 8 oz	
2	C3-8605	1	JUMPER LONG	
3	2T-6213	1	THERMOSTAT, 550V B-200	1/4 TURN CLOWISE = 30°F RISE
4	C3-Y2611	1	BRACKET-KETTLE HINGE CP	
	C3-Y2612	1	BRACKET-KETTLE PLATED	
5	2C-1589	2	SCREW, MACHINE	
	2C-Y1221	2	BOLT 1/4-20X1/2 HEX STL NP	
7	C3-59024	1	ELEMENT CLAMP ASSY	
8	2C-1810	3	WASHER 3/16 STL NP	
9	2C-1512	3	SCREW 10-24X3/8 RHP STL	
13	C3-Y4053	1	INSULATION MANNINGLAS	
14	2C-8569	1	SCREW 1/4-20X2 ST SET	
15-19	C3-59007 NLA	1	KETTLE HANDLE ASSY	#4936652, #5916854 & BELOW
15	2P-8880	1	SPRING-HANDLE TORSION	
16	2A-8838	1	ROD, HANDLE PLATED	
17	2R-8293, NLA	1	HANDLE HARDWOOD BLACK	
18	2C-1811	1	WASHER 1/4 STL	
19	2C-2581	2	NUT 1/4-20 BR ACORN NP	
24	2C-9607	1	SCREW-ADJUST SG1508	#4936652, #5916854 & BELOW
25	2A-5401	1	PIN-COTTER 3/32DX3/4 SS	#4936652, #5916854 & BELOW
15-19	C3-49014	1	HANDLE AND ROD ASSY COMPLETE	
	2A-2100	1	PIN-GROOVE 1/80X5/8 ST	
	2A-Y5377	1	ROD-HANDLE-PLATED	
	2R-09-WB-0027	1	HANDLE BLACK 3/8-16	
	2B-Y6139	1	CLIP-HANDLE	
	2P-8880	1	SPRING-HANDLE TORSION	
24	2V-Y5379	1	RETAINER	
25	C3-Y5378	1	CAM	
20-23	C3-59052	1	KETTLE CONDUIT W/WIRES	
20	C3-59029	1	KETTLE LEAD WIRE ASSY	
21	2P-8354	1	CAP-TWIST LOCK L5-15P	
22	2E-8355	1	CONDUIT, FLEXIBLE - 14"	
23	2E-1177	1	CONNECTOR 3/8 TB#266	
	2K-3831	1	BUSHING-7/16 ODX-028	
26	C3-59051	1	KETTLE SHELL ASSY	OLD STYLE 49 & 59
	2C-Y3166	1	WASHER	
	2C-1494	1	SCREW 8-32X1/2 RHP STL NP	
27	2C-2559	1	NUT 10-24 ACHD BR NP	
31	2N-Y5592	1	ELEMENT 1420 WATTS/9.6 OHMS	120V
	2N-Y5593	1	ELEMENT 1420 WATTS/40 OHMS	240V

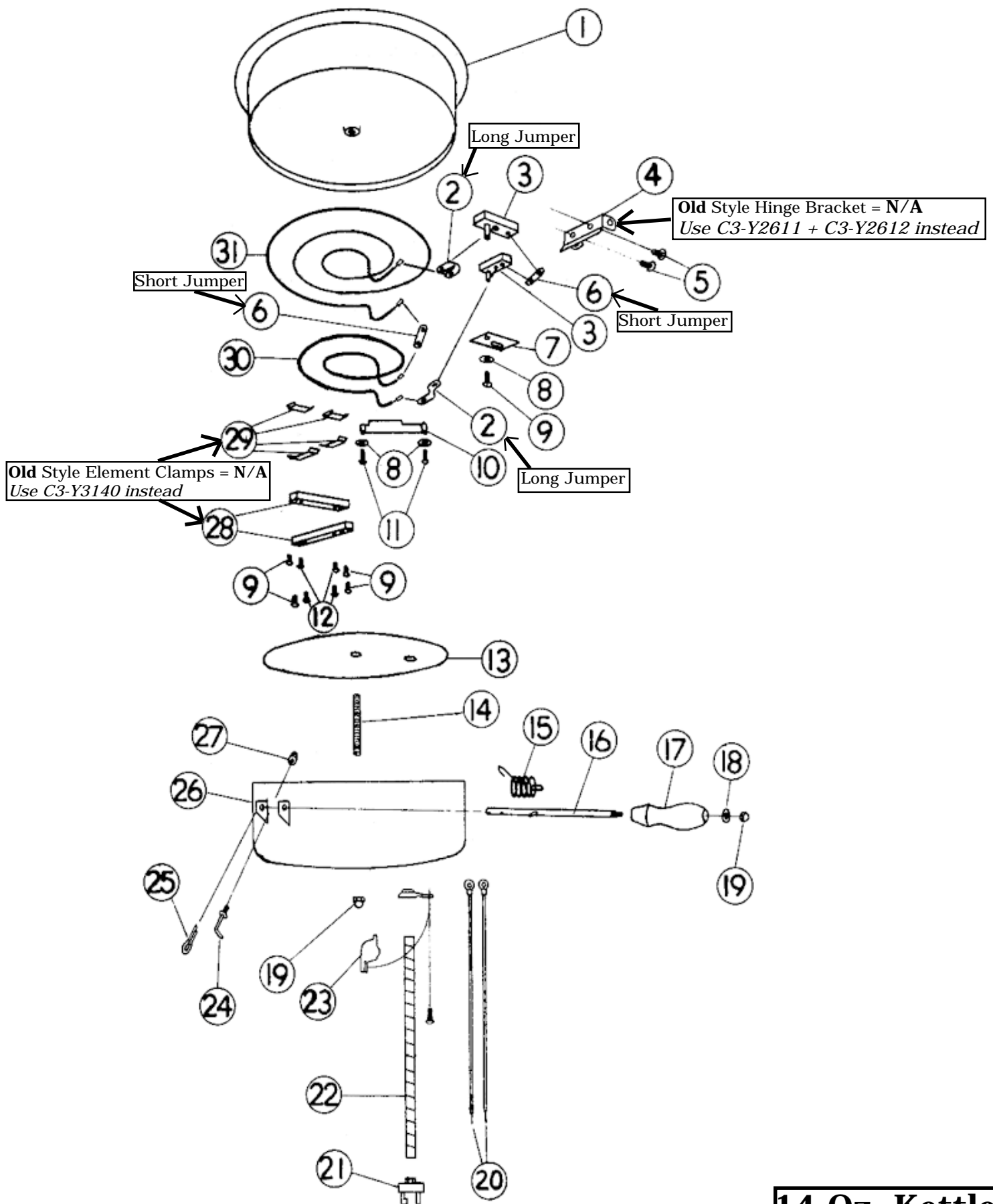

14 Oz. Kettle

MODEL 89 Series

PARTS LIST

EFFECTIVE 01/15/2014 BBE

MODEL 89 Series Machines

Key Number	Part Number	Number Per Unit	Description
1-31	C3-89002	1	14 Oz. Kettle Assembly KETTLE ASSEMBLY COMPLETE - 120V (#8909159 & BELOW) N/A - Use C3-89011 + C3-Y2612 instead
	C3-89011	1	KETTLE ASSEMBLY COMPLETE - 120V (#8909160 & ABOVE) <i>(10 Lbs shipping weight)</i>
	C3-89009	1	KETTLE ASSEMBLY COMPLETE - 240V (#8909160 & ABOVE)
1	2F-8395	1	KETTLE CASTING (Sand Cast Material)
2	C3-8605	2	KETTLE JUMPER - LONG
3	2T-6213	2	THERMOSTAT (1/4 turn clockwise = 30°F rise)
4	C3-8283	1	KETTLE HINGE BRACKET (#8909159 & BELOW) N/A - Use C3-Y2611 + C3-Y2612 instead
	C3-Y2611	1	KETTLE HINGE BRACKET (#8909160 & ABOVE)
5	2C-1589	2	MACHINE SCREW (1/4-20 x 1/2 Flat Head)
	2C-Y1221	2	MACHINE SCREW (1/4-20 x 1/2 Hex Head)
6	C3-8690	2	KETTLE JUMPER - SHORT
7	C3-8568	1	THERMOSTAT CLAMP
8	2C-1810	9	BURR
9	2C-1512	7	SCREW (10-24 x 3/8)
10	C3-8951	1	THERMOSTAT CLAMP
11	2C-1515	2	SCREW (10-24 x 3/4)
13	C3-Y4053	1	KETTLE INSULATION
14	2C-8569	1	STUD (1/4-20 x 2)
15-19, 24,25	C3-59007	1	KETTLE HANDLE ASSEMBLY COMPLETE (#8923059 & BELOW)
15	2P-8880	1	KETTLE HANDLE SPRING
16	C3-8838	1	KETTLE ROD HANDLE w/PIN
17	2R-8293	1	KETTLE HANDLE (wood)
18	2C-1811	1	BURR (1/4)
19	2C-2581	2	ACORN NUT (1/4-20)
24	2C-9607	1	SCREW - ADJUSTING
25	2A-5401	1	COTTER KEY

**IMPORTANT: WHEN ORDERING, SPECIFY VOLTAGE OR TYPE GAS DESIRED
INCLUDE MODEL AND SERIAL NUMBER**

PAGE 1 OF 2

Some items are included for illustrative purposes only and in certain instances may not be available.



Star Manufacturing International, Inc.

PARTS LIST

EFFECTIVE 11-11-03 rb

MODEL 89 Series Machines

Key Number	Part Number	Number Per Unit	Description
			14 Oz. Kettle Assembly
15-19, 24,25	C3-49014	1	KETTLE HANDLE ASSEMBLY COMPLETE (#8923060 & ABOVE)
	2A-2100	1	PIN - GROOVE
	2A-Y5377	1	KETTLE ROD HANDLE
	2R-Y5375	1	KETTLE HANDLE (plastic)
	2C-Y5376	1	CLIP - LATCH HANDLE
	2P-8880	1	KETTLE HANDLE SPRING
	2V-Y5379	1	RETAINER / SPACER
	C3-Y5378	1	CAM
20-23	C3-59052	1	KETTLE CONDUIT COMPLETE (w/wires & twist-loc plug)
20	C3-59029	1	KETTLE LEAD WIRE ASSEMBLY (2 wire set w/terminals)
	2C-9617	2	WIRE TERMINAL
	2I-5062	15	INSULATOR BEAD
21	2P-8354	1	MALE TWIST-LOC PLUG
22	C3-8355	1	KETTLE CONDUIT
	C3-Y3045	1	GROUND STRAP
23	2E-1177	1	SQUEEZE CONNECTOR
	2K-3831	1	BUSHING (for conduit)
26	C3-59051	1	KETTLE SHELL W/WASHER (#8923059 & BELOW) (needs C3-49014 HANDLE also)
	2C-Y3166	1	WASHER (1" x 1/4")
	2C-1494	1	SCREW (holds shell to casting)
27	2C-2559	1	ACORN NUT (10-24)
28,29	C3-Y3140	2	NEW STYLE ELEMENT CLAMP (use qty. 3 each of Key #8 & #9)
8	2C-1810	3	BURR
9	2C-1512	3	SCREW
30	2N-Y5594	1	KETTLE ELEMENT - 120V (300W/ 40 ohms) (SMALL) (blue dot)
	2N-Y5595	1	KETTLE ELEMENT - 240V (300W/ 40 ohms) (SMALL) (red dot)
31	2N-Y5592	1	KETTLE ELEMENT - 120V (1500W/ 9.6 ohms) (blue dot)
	2N-Y5593	1	KETTLE ELEMENT - 240V (1500W/ 9.6 ohms) (red dot) (Element design was changed in 6/87)

**IMPORTANT: WHEN ORDERING, SPECIFY VOLTAGE OR TYPE GAS DESIRED
INCLUDE MODEL AND SERIAL NUMBER**

PAGE 2 OF 2

Some items are included for illustrative purposes only and in certain instances may not be available.



Star Manufacturing International, Inc.

Hi-Temp Wire = 1N-E2052

Right Hinge w/Pin = C3-59019
Screw = 2C-1646

Left Hinge w/Pin = C3-59020
Screw = 2C-1646

Left Leaf Hinge Long = C3-8279
Screw = 2C-1512 (10-24x3/8)
Nut = 2C-2559

Right Leaf Hinge Long = C3-8278
Screw = 2C-1512 (10-24x3/8)
Nut = 2C-2559

Motor Support Assy.
C3-59003

New Style Hinge Bracket
C3-Y2612

The diagram shows an exploded view of a laboratory oven assembly. The main components are labeled with circled numbers: 1 (Oven Body), 2 (Oven Door), 3 (Oven Knob), 4 (Oven Knob Cap), 5 (Oven Knob Cap Screw), 6 (Oven Knob Cap Nut), 7 (Oven Knob Cap Washer), 8 (Oven Knob Cap Seal), 9 (Oven Knob Cap Seal), 10 (Oven Knob Cap Seal), 11 (Oven Knob Cap Seal), 12 (Oven Knob Cap Seal), 13 (Oven Knob Cap Seal), 14 (Oven Knob Cap Seal), 15 (Oven Knob Cap Seal), 16 (Oven Knob Cap Seal), 17 (Oven Knob Cap Seal), 17A (Oven Knob Cap Seal), 17B (Oven Knob Cap Seal), 18 (Oven Knob Cap Seal), 19 (Oven Knob Cap Seal), 20 (Oven Knob Cap Seal), 21 (Oven Knob Cap Seal), 22 (Oven Knob Cap Seal), 23 (Oven Knob Cap Seal), 24 (Oven Knob Cap Seal), 25 (Oven Knob Cap Seal), 26 (Oven Knob Cap Seal), 27 (Oven Knob Cap Seal), 28 (Oven Knob Cap Seal), 29 (Oven Knob Cap Seal), 30 (Oven Knob Cap Seal), 31 (Oven Knob Cap Seal), 32 (Oven Knob Cap Seal), 33 (Oven Knob Cap Seal), 34 (Oven Knob Cap Seal), 35 (Oven Knob Cap Seal), 36 (Oven Knob Cap Seal), 37 (Oven Knob Cap Seal), 38 (Oven Knob Cap Seal), 39 (Oven Knob Cap Seal), 40 (Oven Knob Cap Seal), 41 (Oven Knob Cap Seal), 42 (Oven Knob Cap Seal), 43 (Oven Knob Cap Seal), 44 (Oven Knob Cap Seal), 45 (Oven Knob Cap Seal), 46 (Oven Knob Cap Seal), 47 (Oven Knob Cap Seal), 48 (Oven Knob Cap Seal), 49 (Oven Knob Cap Seal), 50 (Oven Knob Cap Seal).

PARTS LIST

April 7, 2010,

8 oz. & 14 oz. Machines Parts

MODEL **49, 59, 89 Series Machines**

Key Number	Part Number	Number Per Unit	Description & Model Designation
1	C3-Y6683	1	KETTLE & LID SUPPORT
2	C3-59011	1	RIGHT KETTLE LID ASSEMBLY W/HANDLE N/A - No replacement
	2R-1272	1	KNOB - KETTLE LID
	2C-1506	1	SCREW (not shown)
3	2P-Y6231	1	BEARING ASSEMBLY (PLASTIC)
4	C3-59012	1	LEFT KETTLE LID ASSEMBLY
5-13	C3-59053	1	KETTLE LATCH ASSEMBLY COMPLETE
5	C3-Y1470	1	KETTLE LATCH
6	C3-2806	1	KETTLE LATCH SPRING
7	2C-1505	2	SCREW (10-24x3/8)
	2C-1827	2	WASHER-SHAKE (#10) (not shown)
8	2C-1557	1	SCREW (10-24x1-1/2)
9	2C-2559	2	ACORN NUT (10-24)
10	2C-2555	1	ACORN NUT (8-32)
11	2C-1493	1	SCREW (8-32x3/8)
	2C-1825	1	WASHER-SHAKE (#8) (not shown)
12	C3-8313	1	KETTLE LID PIN SPRING
13	C3-2803	1	HINGE LATCH
14	C3-Y2612	1	KETTLE HINGE MOTOR HOUSING (#5909527 & UP)
15	2E-8343	1/3	SWITCH-TOGGLE (QTY.1 ON 59D & 89D ONLY for motor) (QTY.3 ON #4942396, #5917564, #8926996 & ABOVE)
	2E-Y6144	3	SWITCH-ROCKER (#4936951 TO #4942395) (not shown) (#5916883 TO #5917563) (#8923915 TO #8926995)
	2E-3966	2	SWITCH-ROTARY (59D & 89D ONLY for kettle & lights) (not shown)
	2R-7886	2	KNOB-ROTARY SWITCH (not shown)
16	C3-59004	1	MOTOR COVER ASSEMBLY
17	PS-49116	1	MOTOR W/GEAR BOX & LEAD WIRES (120V)
	C3-59050	1	MOTOR W/GEAR BOX & LEAD WIRES (240V)
17a	2A-9556 NLA	1	MOTOR GEAR W/SHAFT (#5900 imprinted) (PLASTIC)
17b	2A-9557	1	MOTOR GEAR (#5318 imprinted) (METAL)
17c	2A-Y1265	1	MOTOR GEAR - SMALL (PLASTIC)
	2I-H6579	4	MOTOR GROMMETS (not shown)
18	C3-8263	1	KETTLE HINGE PIN
19	2A-Y6694	1	HAIRPIN (#4945475, #59118062, #8928211 & BELOW)
20	2A-7939	1	AGITATOR SHAFT
21	2A-Y1555	1	UNIVERSAL
22	2A-5401	1	COTTER PIN
23	2B-8317	4	AGITATOR BLADE (SPRING)(49 & 59 SERIES) (4" LONG)
	2B-8319	4	AGITATOR BLADE (SPRING)(89 SERIES) (4-1/4" LONG)
24	C3-8318	1	AGITATOR COLLAR
25	2C-6170	2	SET SCREW (8-32)

**IMPORTANT: WHEN ORDERING, SPECIFY VOLTAGE OR TYPE GAS DESIRED
INCLUDE MODEL AND SERIAL NUMBER**

PAGE 1
OF 4

Some items are included for illustrative purposes only and in certain instances may not be available.

PARTS LIST

April 7, 2010,

8 oz. & 14 oz. Machines Parts 49, 59, 89 Series Machines

MODEL _____

Key Number	Part Number	Number Per Unit	Description & Model Designation
20-25	C3-59057	1	AGITATOR ASSEMBLY COMPLETE (49 & 59 SERIES) (TO UPDATE/UPGRADE - #4945475, #59118062 & BELOW)
20-25	C3-89006	1	AGITATOR ASSEMBLY COMPLETE (89 SERIES) (TO UPDATE/UPGRADE - #8928211 & BELOW)
20	2A-Y7683	1	AGITATOR SHAFT (4-7/16" LONG)
20	2A-Y7217	1	AGITATOR SHAFT (5-7/16" LONG)
	2C-Y6508	1	GROOVE - PIN (not shown)
21	2A-Y1555	1	UNIVERSAL
22	2A-Y6694	1	CLIP - SHAFT
23	2B-Y7218	1	AGITATOR BLADE (49 & 59 SERIES) (8-1/4" LONG)
	2B-Y7219	1	AGITATOR BLADE (89 SERIES) (8-3/4" LONG)
24	2A-Y6207	1	AGITATOR COLLAR
25	2C-6170	2	SET SCREW (8-32)
20-25	C3-49502	1	AGITATOR ASSEMBLY COMPLETE (49 & 59 SERIES) (#4945476, #59118063 & ABOVE) N/A-USE C3-59057 Instead
	C3-89502	1	AGITATOR ASSEMBLY COMPLETE (89 SERIES) (#8928212 & ABOVE) N/A-USE C3-89006 Instead
26	2S-Y2238	1	WARMER LAMP (120V, 250W)
	2S-Y1508	1	WARMER LAMP - RED (120V, 250W) (used on 49D only)
27-29	C3-Y7940	1	CORN DRAWER ASSEMBLY (not as shown)
29	2R-4391	1	HANDLE
	2R-Z0872	1	KNOB (not shown)
CUSTOMER'S VIEW, NOT SERVER'S			
30-33	C3-49011	1	RIGHT DOOR COMPLETE (49)
	C3-49052	1	RIGHT DOOR COMPLETE (49D) (#4905055 & BELOW) N/A-No replacement
	C3-49065	1	RIGHT DOOR COMPLETE (49D) (#4905056 & ABOVE)
	C3-59069	1	RIGHT DOOR COMPLETE (59 & 89 SERIES, 89W) N/A-No replacement
30	C3-49068	2	DOOR HINGE ASSEMBLY-RIGHT (49D) (#4905056 & ABOVE)
	C3-59054	2	DOOR HINGE ASSEMBLY-RIGHT
31	C3-Y2713	1	STRIKE - MAGNETIC LATCH
32	2R-1272	1	KNOB - DOOR (2C-1506 = SCREW)
33	C3-Y2730	2	DOOR - PLEXIGLASS (49) (15" x 9-1/2" W/2 holes)
	C3-Y2979	2	DOOR - PLEXIGLASS (49D) (#4905056 & ABOVE) (15" x 9-1/2" W/3 holes)
	C3-Y2729	2	DOOR - PLEXIGLASS (59 & 89 SERIES, 89W) (15" x 13" W/2 holes) N/A-No replacement
	2M-Y1755	1	INSTRUCTIONS - CLEAR (not shown)

**IMPORTANT: WHEN ORDERING, SPECIFY VOLTAGE OR TYPE GAS DESIRED
INCLUDE MODEL AND SERIAL NUMBER**

PAGE 2
OF 4

Some items are included for illustrative purposes only and in certain instances may not be available.

PARTS LIST

April 7, 2010,

8 oz. & 14 oz. Machines Parts

MODEL **49, 59, 89 Series Machines**

Key Number	Part Number	Number Per Unit	Description & Model Designation
31-34	C3-49012	1	CUSTOMER'S VIEW, NOT SERVER'S
	C3-49053	1	LEFT DOOR COMPLETE (49)
			LEFT DOOR COMPLETE (49D) (#4905055 & BELOW)
			N/A-No replacement
	C3-49066	1	LEFT DOOR COMPLETE (49D) (#4905056 & ABOVE)
	C3-59070	1	LEFT DOOR COMPLETE (59 & 89 SERIES, 89W)
			N/A-No replacement
31	C3-Y2713	1	STRIKE - MAGNETIC LATCH
32	2R-1272	1	KNOB - DOOR (2C-1506 = SCREW)
34	C3-49069	2	DOOR HINGE ASSEMBLY-LEFT (49D) (#4905056 & ABOVE)
	C3-59055	2	DOOR HINGE ASSEMBLY-LEFT
	2M-Y1755	1	INSTRUCTIONS - CLEAR (not shown)
35,36	2Q-Y2608	3	GLASS (49 SERIES) (PURCHASE LOCALLY, if possible) (ALL SIDES)
			(24-5/8 x 19-5/8 x 1/8 double strength)
35	2Q-8344	1	FRONT GLASS (59 & 89 SERIES, 89W)
			(PURCHASE LOCALLY, if possible)
			(26-5/8 x 24-5/8 x 1/8 double strength)
	2Q-Y2912	1	FRONT GLASS (89T, TIFFANY)
	2M-Y2737	1	SIGN - FRONT GLASS (89P, PATRIOT)
	2Q-8345	2	SIDE GLASS (59 & 89 SERIES, 89W)
			(PURCHASE LOCALLY, if possible)
			(22-5/8 x 24-5/8 x 1/8 double strength)
	2Q-Y2913	2	SIDE GLASS (89T, TIFFANY)
	2M-Y2738	2	SIGN - SIDE GLASS (89P, PATRIOT)
37	2I-Z0160	6	GLASS CHANNEL (UPRIGHT) (Will need to be cut to 24-11/16")
38	2I-Z0160	2	GLASS CHANNEL (SIDE, BOTTOM) (59 & 89 SERIES, 89W)
			(Will need to be cut to 21-13/16")
39	2I-Z0160	1	GLASS CHANNEL (FRONT, BOTTOM) (59 & 89 SERIES, 89W) (25-3/8")
	2I-Y2609	3	GLASS CHANNEL (BOTTOM) (49 SERIES)
40	C1-S7515	1	LEAD IN CORD - 120V (49 SERIES)
	C3-49094	1	LEAD IN CORD - 240V (49 SERIES)
	C3-59022	1	LEAD IN CORD - 120V (59 SERIES)
	C3-89008	1	LEAD IN CORD - 120V (89 SERIES)
	C3-59023	1	LEAD IN CORD - 240V (59 & 89)
	C3-89001	1	LEAD IN CORD - 120V (59D, 59SL, 89D, 89SL)
	C3-59036	1	LEAD IN CORD - 240V (59D, 59SL, 89D, 89SL)
	2K-Y2968	1	BUSHING - STRAIN RELIEF (120V)
	2K-Y2967	1	BUSHING - STRAIN RELIEF (240V)
	2E-8715	1	FEMALE WALL RECEPTACLE (120V only)
	C3-49003	1	TOP ASSEMBLY (49) N/A-No replacement
	C3-49054	1	TOP ASSEMBLY (49D, #4905055 & BELOW)
	C3-49067	1	TOP ASSEMBLY (49D, #4905056 & ABOVE)
	C3-59014	1	TOP ASSEMBLY (59 & 89) N/A-No replacement
41	C3-59015	1	TOP ASSEMBLY (59D & 89D) (less sign) N/A-No replacement
	C3-59110	1	TOP ASSEMBLY (89SL)

**IMPORTANT: WHEN ORDERING, SPECIFY VOLTAGE OR TYPE GAS DESIRED
INCLUDE MODEL AND SERIAL NUMBER**

PAGE 3
OF 4

Some items are included for illustrative purposes only and in certain instances may not be available.

PARTS LIST

April 7, 2010,

8 oz. & 14 oz. Machines Parts

MODEL **49, 59, 89 Series Machines**

Key Number	Part Number	Number Per Unit	Description & Model Designation
42,43	2C-9788	1	MAGNET & BRACE
44	2E-T1042	1	FEMALE TWIST LOCK RECEPTACLE
45	C3-59035	1	PILOT LIGHT ASSEMBLY - 120V (49, 59, 89, 89W)
	C3-59034	1	PILOT LIGHT ASSEMBLY - 240V (49, 59, 89)
	C3-59047	1	PILOT LIGHT ASSEMBLY - 120V (49D, 59D, 89D)
	C3-59048	1	PILOT LIGHT ASSEMBLY - 240V (49D, 59D, 89D) N/A-No replacement
46	2E-Y5921	1	SOCKET - LAMP
	C3-Y6129	1	CLIP
	C3-Y4526	1	LAMPSHIELD (49 & 59 SERIES)
	C3-Y4122	1	LAMPSHIELD (89 SERIES)
47	C3-8725	1	COVER - CONTROL (59, 89) (not shown)
	C3-8386	1	COVER - CONTROL (59D, 89D) (not shown)
	C3-Y2614	1	COVER - CONTROL (49 SERIES) (not shown) (alias SWITCHPLATE)
48	C3-49106	1	FRONT LOWER DOOR ASSEMBLY (49 SERIES)
	C3-59106	1	FRONT LOWER DOOR ASSEMBLY (59 & 89 SERIES)
	C3-89058	1	FRONT LOWER DOOR ASSEMBLY (89W)
	2A-Y3405	4	FOOT
	2M-Y6459	1	DECAL "FRESH POPPED POPCORN" (59, 89) N/A-No replacement
	2M-Y2632	1	DECAL - SWITCHES, "KETTLE & WARMER"
	2M-Y6306	1	DISPLAY SIGN (49SL) (back) N/A-No replacement
	2M-Y6307	1	DISPLAY SIGN (49SL) (front) N/A-No replacement
	2M-8506	1	DISPLAY SIGN (59D, 89D) N/A-No replacement
	2M-Y6453	1	DISPLAY SIGN (49)
	C3-Y2721	1	DISPLAY SIGN (49D) (woodgrain design) N/A-No replacement
	2M-Y2062	1	DISPLAY SIGN (89W)
	2M-Y6460	2	DISPLAY SIGN (89SL) N/A-No replacement
	2S-8373	2	DISPLAY LAMP (59D, 89D) N/A-No replacement
	C3-Y2722	1	RETAINER BOTTOM (for sign)
	2N-8396	1	WARMER ELEMENT - 120V (not shown)
	2N-8397	1	WARMER ELEMENT - 240V (not shown)
	C3-8334	1	CORN SCOOP - METAL (not shown)
	2L-Y4640	1	CORN CUP (3/4 cup) (not shown)
	2L-Y4639	1	OIL CUP (1/4 cup) (not shown)

**IMPORTANT: WHEN ORDERING, SPECIFY VOLTAGE OR TYPE GAS DESIRED
INCLUDE MODEL AND SERIAL NUMBER**

PAGE 4
OF 4

Some items are included for illustrative purposes only and in certain instances may not be available.